



## OKS 265 - Product Information

### Fields of Application:

Full synthetic white paste for lubrication of friction- and sliding points under high shock, jerky and vibration stress. Especially suited for chuck jaw lubrication on machine tools. Prevents reliably from fretting corrosion. Long-term lubrication of sliding surfaces sensitive to dirt, e.g. controlling or drive units, under influence of humidity e.g. on machines for automatic filling, labeling, packaging, etc.

### OKS 265 Chuck Jaw Paste

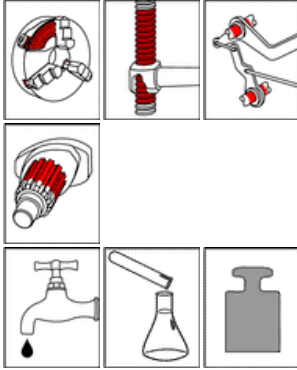

### Advantages and Benefits:

Best suited for contamination-free assembly- and long-time lubrication. High efficiency due to well balanced solid lube combination. Manyfold application wherever machine components work in humid environment. Minimum consumption by applying a thin, high effective coating. Resistant to water, steam and aqueous coolants.

### Application:

For best adhesion, clean contamination and other lubricants from thread and slide surfaces. Best way is to clean mechanically first (for example, with a wire brush) and then with OKS 2610 or OKS 2611 universal cleaning agent. Use a brush, spatula or similar to apply evenly a suitable quantity of paste to the function surface. The paste will also act as a sealant. Do not use paste instead of grease and mix only with suitable lubricants. Our customer advice service will be pleased to help should you have any further questions.

### Additional Information:

Packaging (article number):

- 1 kg tin (00265034)
- 400 g cartridge (00265019)
- 5 kg hobbock (00265050)
- 25 kg hobbock (00265062)

Version:  
E-10.1/04

The data in this brochure are the result of extensive testing and experience and meet the latest stage of engineering. Due to the diversity of application possibilities and technical realities they can only be recommendations and are not arbitrarily transferable; thus no obligations, liability or warranty claims can be derived herefrom. We accept liability for the fitness of our products for particular purposes and accept such liability in writing in the individual case. In any event any justified warranty claims shall be limited to the delivery of replacement goods which are free from defect or, in the event that such subsequent improvement fails, to reimbursement of the purchase price. Any and all further claims, in particular but without limitation any liability for consequent damage, shall be excluded. Prior to use own testing must be done to prove suitability. The data are subject to change for the sake of technical progress. ® = Registered Trademark



## OKS 265 Chuck Jaw Paste

### Technical Data

	Norm	Conditions	Measurement	Value
<b>Base Oil</b>				
Type				Polyalphaolefine
<b>Thickener</b>				
Type				Lithium hydroxystearate
Unworked penetration	DIN ISO 2137	no shear stress	0,1 mm	260 - 290
Drop point	DIN ISO 2176		°C	approx. 160
<b>Additions</b>				
Solid lubricants, type				White solid lubricants
<b>Application Data</b>				
Density	DIN EN ISO 3838	+20°C	g/cm <sup>3</sup>	1,0
Colour				light coloured
<b>Service Temperatures</b>				
Minimum service temperature			°C	-45
Maximum service temperature (lubrication)			°C	110
<b>Wear Protection Tests</b>				
VBT- weld load (Four ball test rig)	DIN 51 350-4		N	4.200
<b>Friction Values</b>				
Thread friction value	DIN EN ISO 16047	Screw ISO 4017, M10x55-8.8 plain Nut ISO 4032, M10-10, plain	μ	thread = 0,1

The data in this brochure are the result of extensive testing and experience and meet the latest stage of engineering. Due to the diversity of application possibilities and technical realities they can only be recommendations and are not arbitrarily transferable; thus no obligations, liability or warranty claims can be derived herefrom. We accept liability for the fitness of our products for particular purposes and accept such liability in writing in the individual case. In any event any justified warranty claims shall be limited to the delivery of replacement goods which are free from defect or, in the event that such subsequent improvement fails, to reimbursement of the purchase price. Any and all further claims, in particular but without limitation any liability for consequent damage, shall be excluded. Prior to use own testing must be done to prove suitability. The data are subject to change for the sake of technical progress. ® = Registered Trademark