



OKS 571 - Product Information

Fields of Application:

Dry lubrication of most various materials sliding on top of or rubbing against each other (such as metals, wood, ceramic, rubber, and also adhesives or paintable plastics). For packaging machines, slide surfaces in the plastics and textile industry, rollers and chutes in conveying systems, and so on. Anti-stick coating of seals or sealing surfaces of all kinds to prevent sticking-on, prevents from squeaking noises of soft on hard materials (rubber on glass, for example), for water-repellent impregnation of absorbent materials or as a separating film in cast resin applications.

OKS 571

PTFE Bonded Coating, Spray

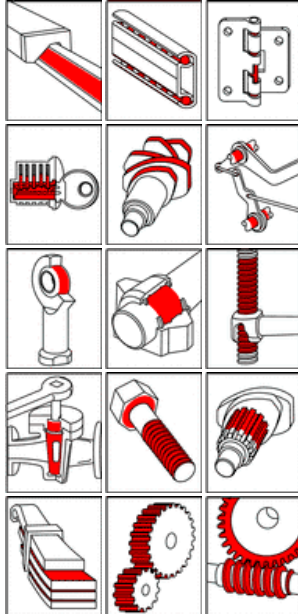

Advantages and Benefits:

Highly effective due to good adhesion to prepared substrates. Eminently suitable for easy-running lubrication of the most differing pairs of materials. Colorless and odorless low-friction coating with non-stick properties.

Application:

For best adhesion, clean the surfaces. Best way is to clean mechanically first and then with OKS 2610 or OKS 2611 universal cleaner. The surfaces to be treated must be bright metal and dry. Chemical or mechanical pretreatment of surfaces may extend the service life of the non-stick paint. Stir the paint thoroughly before use. Spray an evenly thin film to the prepared surfaces, spraying distance should be 20-30 cm. Avoid local excess (such as 'curtaining'). Drying and curing conditions as per the following technical data. Our customer advice service will be pleased to help should you have any further questions.

Additional Information:

Packaging (article number):
- 400 ml Spray (00571004)

Version:
E-05.1/06

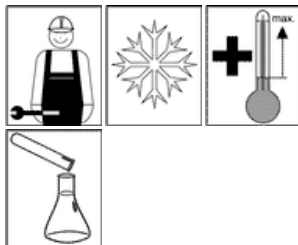

The data in this brochure are the result of extensive testing and experience and meet the latest stage of engineering. Due to the diversity of application possibilities and technical realities they can only be recommendations and are not arbitrarily transferable; thus no obligations, liability or warranty claims can be derived herefrom. We accept liability for the fitness of our products for particular purposes and accept such liability in writing in the individual case. In any event any justified warranty claims shall be limited to the delivery of replacement goods which are free from defect or, in the event that such subsequent improvement fails, to reimbursement of the purchase price. Any and all further claims, in particular but without limitation any liability for consequent damage, shall be excluded. Prior to use own testing must be done to prove suitability. The data are subject to change for the sake of technical progress. ® = Registered Trademark



OKS 571 PTFE Bonded Coating, Spray

Technical Data

	Norm	Conditions	Unit	Value
Solid lubricants				
Type				PTFE
Binder				
Type				Silicone resin
Solvents				
Type				Benzine, ketone
Flash point	DIN 51 755 (-2)	<65°C (<5°C)	°C	< -18
Film layer				
Optimum layer thickness	DIN 50 981/50 984	DIN 50 982-2	µm	5 - 20
Application temperature			°C	Room temperature
Drying time		at 20°C	min	15
Surface coverage			m²/Tin	3
Application Data				
Density	DIN EN ISO 3838	+20°C	g/ml	0,85
Colour				light-coloured
Service Temperatures				
Minimum service temperature			°C	-180
Maximum service temperature			°C	260
Coefficients of friction				
Thread friction	DIN EN ISO 16047		µ	0,10
Press- fit- test	E DIN 51 833		µ	0,07, no chatter

The data in this brochure are the result of extensive testing and experience and meet the latest stage of engineering. Due to the diversity of application possibilities and technical realities they can only be recommendations and are not arbitrarily transferable; thus no obligations, liability or warranty claims can be derived herefrom. We accept liability for the fitness of our products for particular purposes and accept such liability in writing in the individual case. In any event any justified warranty claims shall be limited to the delivery of replacement goods which are free from defect or, in the event that such subsequent improvement fails, to reimbursement of the purchase price. Any and all further claims, in particular but without limitation any liability for consequent damage, shall be excluded. Prior to use own testing must be done to prove suitability. The data are subject to change for the sake of technical progress. ® = Registered Trademark